



PILLAR TIME

Opening up the kitchen meant moving the supporting walls and corresponding ductwork to other locations. A stately post, dressed up with some decorative moulding, now provides the necessary structural support.

SOARING STORAGE

The kitchen now boasts a whopping 30 percent more storage, with double-height cabinets stretching to the ceiling and a pantry wall to the left of the island.

MAPLE CABINETRY IN CUSTOM MAHOGANY FINISH, KENPRIDE.COM.

RECIPE

for a Reno

Interior designer Jane Lockhart cooks up a handsome kitchen makeover for a growing family.

BY KAREN KIRK
PHOTOGRAPHY BY BRANDON BARRÉ
DESIGN BY JANE LOCKHART

IN THE 12 YEARS since the homeowners first moved into this Toronto-area home, their family doubled in size, making the already cramped kitchen feel positively puny. The inefficient layout combined with bland blond-wood cabinetry called for a major makeover helmed by none other than interior designer Jane Lockhart. Serving up a spacious floor plan, abundant storage and refined finishes, Lockhart's dramatic renovation reads like the ultimate recipe for a "new traditional" kitchen.

ARCHITECT SERIES II BOTTOM-FREEZER STAINLESS-STEEL REFRIGERATOR, KITCHENAID.CA. CONSTRUCTION, [GEMCA CONTRACTING](http://GEMCA.CONTRACTING), TORONTO, 416-723-7129.

FLOOR SHOW

The original bleached oak flooring was replaced with wide-plank unfinished Canadian red oak hardwood that was custom-stained to a light taupe to match the staircase in the adjoining foyer. The homeowners love the contrast between the light-coloured floor and the dark cabinetry.

FLOORING, FLOORSDIRECTWEST.COM.

LONG ISLAND

Topped with a gorgeous slab of granite in waves of white, taupe and grey, the eight-by-four-foot island comfortably seats five, granting the homeowners' wishes for an eat-in kitchen. Open shelves on both ends of the island display favourite cookbooks and pretty pitchers.

GRANITE IN PIRACEMA, MONDIALGRANITE.COM. GE102 STAINLESS-STEEL UNDERMOUNT SINK, GEMINSINK.COM. GOLD DIGGER FLEXIBLE-SPOUT FAUCET IN CHROME, BLANCOCANADA.COM. GE CAFÉ DUAL-FUEL CONVECTION RANGE, GEAPPLIANCES.COM. WALL-MOUNT 30-INCH STAINLESS-STEEL RANGE HOOD, KOBERANGEHOODS.COM. SUNPAN BAR STOOLS, COSTCO.COM. GENIUS PRESTIGE MICROWAVE, PANASONIC.CA. VASES, HOMESENSE.CA.

BRIGHT IDEAS

Strategically placed low-voltage halogen pot lights illuminate the entire space, while under-cabinet halogen lights provide task lighting for countertops and accent lighting over the island gives the room a shot of style. Each light source is operated by a separate switch with a dimmer to save energy and create just the right ambience.

KICHLER HATTERAS BAY PENDANT LIGHTS, LIVINGLIGHTING.COM.



CULTURED COUNTER

After years of living with laminate, the homeowners are thrilled with the luxe quartz countertop that runs along the rear wall. A crisp white marble mosaic backsplash adds texture and plays against the dark cabinetry. The corner cabinet is fitted with convenient sliding baskets for easy access to baking supplies.

QUARTZ IN MISTY CARRERA, CAESARSTONE.CA. POLISHED CARRERA AND SILVER MARBLE MOSAIC BACKSPLASH, CERAMICTILE WORLD.COM. BLIND CORNER UNIT, LEEVALLEY.COM. KITCHENAID PROFESSIONAL 600 SERIES STAND MIXER, KITCHENAID.CA.



DOUBLE DUTY

Like two dishwashers in one, this Energy Star-rated model has stacked drawers that can operate in tandem, or one at a time for lighter loads. Measuring just two feet wide, it's a space-saver as well.

DOUBLE DISHDRAWER DISHWASHER IN STAINLESS STEEL, FISHERPAYKEL.COM.

the floor plan

BEFORE

Although there was ample living space on the main floor of the home, the original kitchen was crammed into a corner, cut off by an oddly angled floating wall that housed the fridge but offered limited counter space and storage. Cramping the kitchen's style even further, a laundry room was squeezed into the space along the back wall.

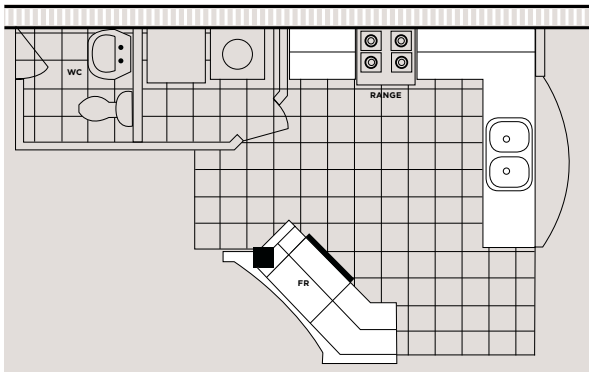

OUR EXPERT
Jane Lockhart, principal designer at Jane Lockhart Interior Design, janelockhart.com

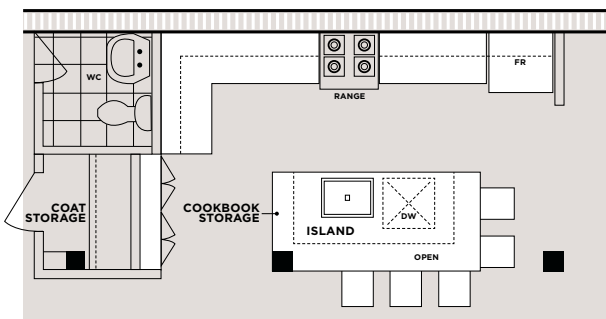

AFTER

The floating wall and laundry room were removed, creating breathing room for new floor-to-ceiling cabinets and a spacious multipurpose island. Lockhart's efficient new layout brought the three points of the "kitchen triangle" closer together: In this configuration, the stainless-steel stove and fridge are on the exterior wall, with the sink directly opposite in the island.



get the look

Inspired by Jane Lockhart's luxe kitchen design? Here's how to bring her sophisticated style home.

KICHLER HATTERAS BAY PENDANT LIGHT IN POLISHED NICKEL, \$299, LIVINGLIGHTING.COM.



ORIGINS BY BENJAMIN MOORE ULTIMATE INTERIOR PAINT IN CHESTERFIELD TAN OR123, \$45 PER GALLON, CANADIANTIRE.CA.



RAMSJO 15-INCH BASE CABINET WITH SHELF, DRAWER AND DOOR IN BLACK-BROWN, \$198, IKEA.CA.

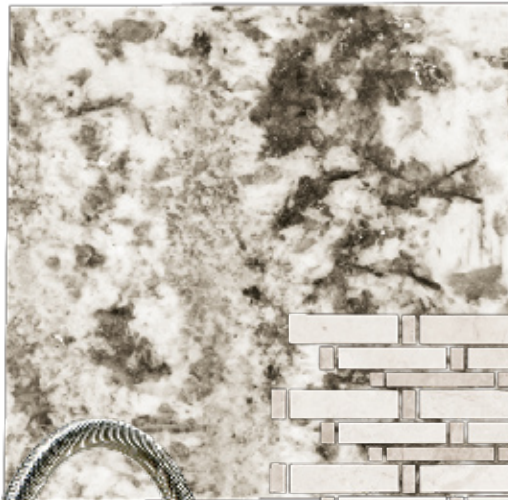

GRANITE IN TORRONCINO, \$22 PER SQUARE FOOT, NEWAGEGRANITEAND MARBLE.COM.



GOLD DIGGER FLEXIBLE-SPOUT FAUCET IN CHROME, \$866, BLANCOCANADA.COM.



POLISHED CARRERA AND SILVER MARBLE MOSAIC TILES, \$16 PER SQUARE FOOT, CERAMICTILEWORLD.COM.

URBAN LOFT COLLECTION WIRE-BRUSHED WHITE-WASHED OAK 6-FOOT-BY-6-INCH PLANKS IN CHELSEA CREAM, \$9 PER SQUARE FOOT, LAUZONLTD.COM.



GE CAFÉ 30-INCH FREESTANDING DUAL-FUEL CONVECTION RANGE WITH BAKING DRAWER, \$3,299, GEAPPLIANCES.COM.



ARTISAN STAND MIXER IN METALLIC CHROME, \$500, KITCHENAID.CA.



Find 10 affordable ways to spruce up your kitchen at canadianliving.com/kitchenupdates.